

Single-Ended Cordsets

- Single-ended male straight and 90°
- Single-ended female straight and 90°

Single-ended cordsets can be used in a variety of applications. Profibus cordsets are designed to connect one node to the next, with the flying lead end being connected to either a remote Profibus I/O card or a field-attachable Micro-Change® connector, providing quick-disconnects on both ends. Male connectors are supplied with externally threaded coupling nuts while female connectors are supplied with internally threaded coupling nuts. This enables the end user to daisy chain data lines in a variety of configurations.

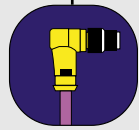

- PUR jacketed for chemical and oil resistance
- Low-resistance contact design
- Leaded end allows for easy field termination
- 360° shielded head design to reduce RFI/EMI

Single-Ended Cordsets

Specifications

CONNECTOR DIMENSIONS

Male Straight

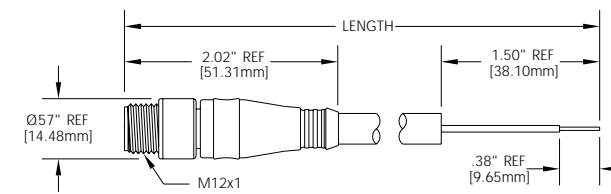

FIG 1

Male 90°

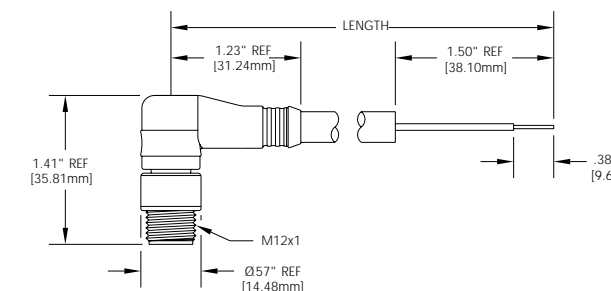

FIG 2

Female Straight

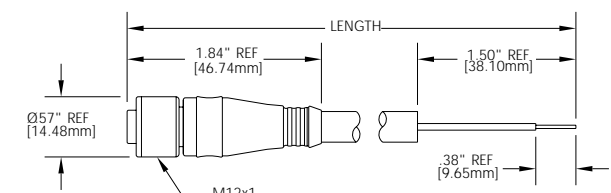

FIG 3

Female 90°

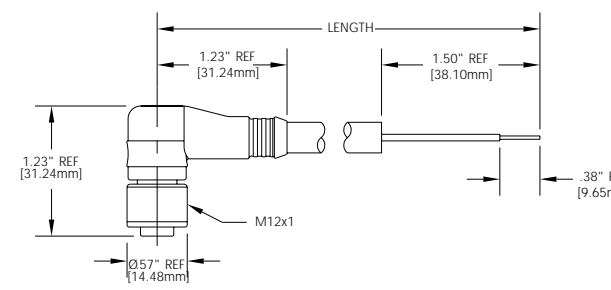

FIG 4

MECHANICAL
 CONNECTOR FACE: NYLON 6/6
 MOLDED BODY: PUR
 O-RING: NITRILE RUBBER
 COUPLING NUT: ZINC DIECAST W/ BLACK EPOXY COAT (UNSHIELDED) OR NICKEL-PLATED BRASS (360° SHIELDED)

CABLE
 OUTSIDE DIAMETER: 0.338" (8.6 mm)
CABLE CONSTRUCTION
 JACKET MATERIAL: PUR
 INNER MATERIAL INSULATION: POLYETHYLENE
 SHIELD TYPE: ALUMINUM FOIL 100%
 CONDUCTOR: TINNED COPPER BRAID 80%
 TWISTED PAIR 0.34 mm²
 STRANDED COPPER WIRE

CABLE FLEX INFORMATION
 TORSION: SURVIVED MORE THAN 2 MILLION CYCLES AT 360° OVER 1 M
 C-TRACK: SURVIVED MORE THAN 3 MILLION CYCLES AT ACCELERATION 10 M/s² AND PROCESS SPEED OF 5 M/s
 BEND RADIUS: 10 X CABLE DIAMETER

ELECTRICAL
 VOLTAGE RATING: 250V AC/DC
 AMPERAGE: 4A

ENVIRONMENTAL
 PROTECTION: IP67, NEMA 6P
 AMBIENT OPERATING TEMP: -4° TO 176° F (-20° TO 80° C) MOVING

RECEPTACLE DIMENSIONS

Female Receptacle

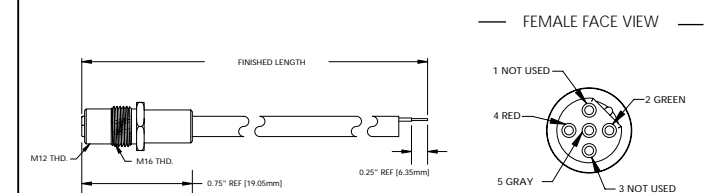

FIG 5

Male Receptacle

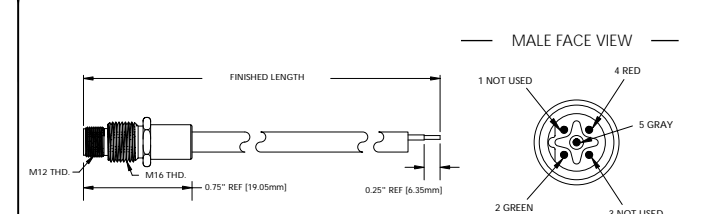

FIG 6

Single-Ended Cordsets

FACE VIEWS	MALE		FEMALE	
COLOR CODE	1 - NOT USED 2 - GREEN(BUS-A)	3 - NOT USED 4 - RED(BUS-B)	5 - SHIELD	
VOLTAGE	250V AC / DC			
CURRENT	4A			
CABLE	#22 AWG			

MALE	FIG	SINGLE-ENDED CORDSETS 2 METERS LONG
STRAIGHT	1	B05S06PP4M020
90°	2	B05S07PP4M020
MATING RECEPTACLE*	5	BR5U70APP4M0103
FEMALE	FIG	SINGLE-ENDED CORDSETS 2 METERS LONG
STRAIGHT	3	B05S00PP4M020
90°	4	B05S01PP4M020
MATING RECEPTACLE*	6	BR5U76PP4M0103

CATALOG OPTIONS

* See page 98-101 for additional mating receptacles

Use the following chart to modify your part's specifications

B05S01PP4M020

CONNECTOR TYPE	CONNECTOR CONFIGURATION	CABLE LENGTH
360° SHIELDED HEAD S	STRAIGHT FEMALE 00	2 METERS M020
UNSHIELDED HEAD O	90° FEMALE 01	5 METERS M050
	STRAIGHT MALE 06	
	90° MALE 07	